

# Site Plan – Imperial Promenade



## PROJECT DATA

PROJECT NAME: YOGASIX - LA HABRA, CA

PROJECT LOCATION: 1202 S. IDAHO ST,  
SUITE 1  
LA HABRA, CA 90631

**GOVERNING CODES:**  
ALL WORK SHALL BE IN COMPLIANCE WITH, BUT NOT LIMITED TO,  
THE REQUIREMENTS OF THE FOLLOWING AND ANY OTHER STATE AND  
LOCAL CODES HAVING JURISDICTION:

BUILDING: 2019 CALIFORNIA BUILDING CODE  
MECHANICAL: 2019 CALIFORNIA MECHANICAL CODE  
PLUMBING: 2019 CALIFORNIA PLUMBING CODE  
ELECTRICAL: 2019 CALIFORNIA ELECTRICAL CODE  
ENERGY: 2019 CALIFORNIA ENERGY CODE  
2019 CALIFORNIA GREEN BUILDING STANDARDS  
ADMINISTRATIVE: 2016 CALIFORNIA ADMINISTRATIVE CODE  
ACCESSIBILITY: 2019 CALIFORNIA BUILDING CODE - CHAPTER 11B

FIRE SPRINKLERS: Yes

**OCCUPANT LOAD:**

PROPOSED OCCUPANCY: B (A3<50) IBC SECTION 303.1.2 (1)

ROOM NAME	AREA	OCCUPANT LOAD FACTOR	CALCULATED TOTAL OCCUPANTS
EQUIPMENT	147 SF	300 SF	1
LOBBY RETAIL	466 SF	60 SF	8
MECH.	49 SF	300 SF	1
STUDIO	882 SF	50 SF	18
UNISEX RESTROOM	63 SF	0 SF	
UNISEX RESTROOM	63 SF	0 SF	
UTILITY	58 SF	300 SF	1
<b>TOTAL OCCUPANTS</b>			<b>29</b>

YOGASIX LEASE AREA (GROSS): 1831 SF

EXIT REQUIREMENTS:  
TOTAL REQUIRED: 1; TOTAL PROVIDED: 1

**PLUMBING FIXTURE LOAD:**  
REQUIRED: 2 - ACCESSIBLE RESTROOMS  
PROVIDED: 2 - ACCESSIBLE UNISEX RESTROOMS

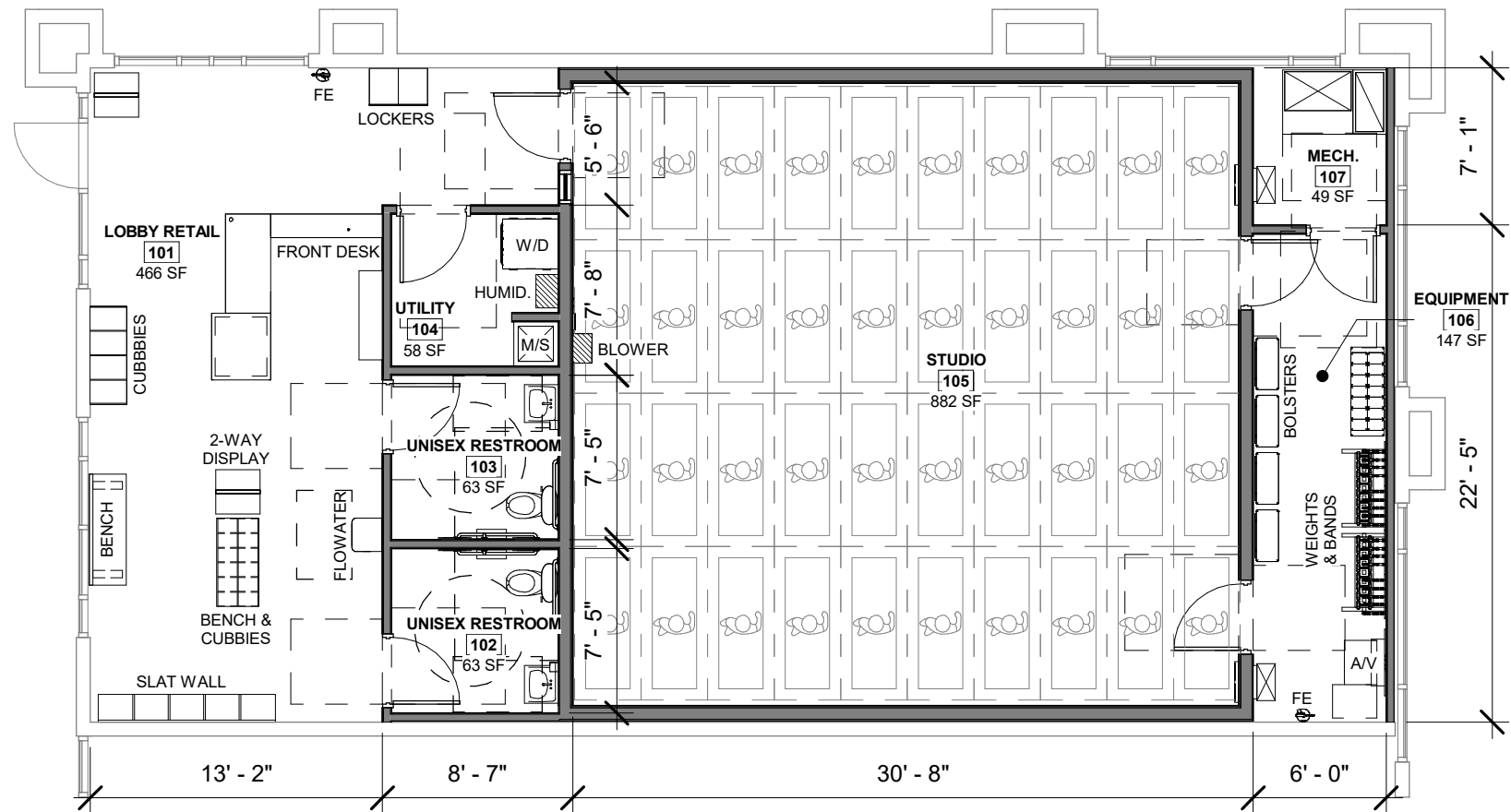

1 PRELIMINARY FLOOR PLAN  
SCALE: 1/8" = 1'-0"